

NOTE:  
This drawing only shows internal floor space, balconies are shown on general arrangement plans and areas depicted on HGA

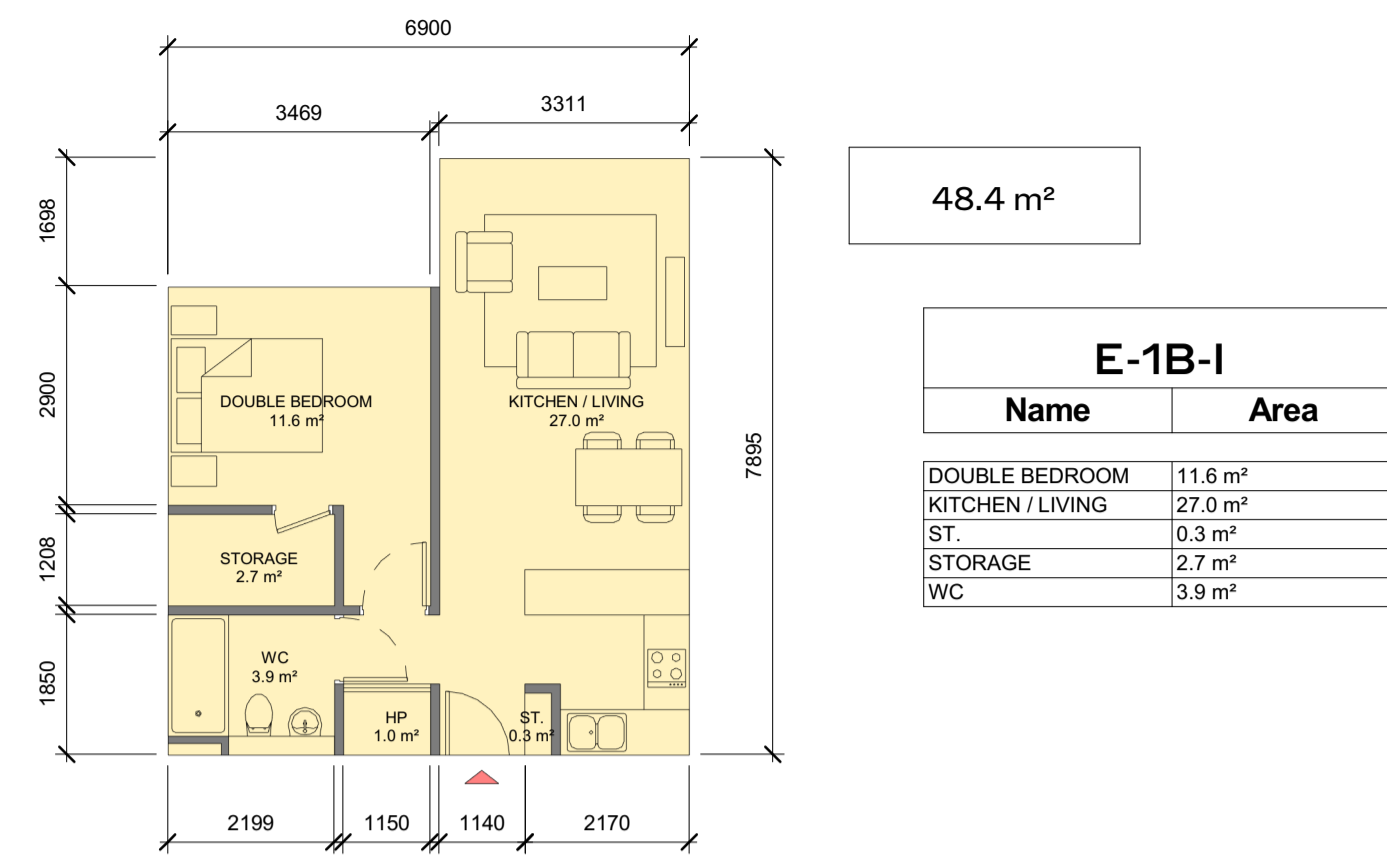

E-1B-I - SPACE REQUIREMENTS											
Apartment Area	Required Apartment Area	Required Area Met	Kitchen - Living Area	Required Kitchen - Living Area	Required Area Met	Total Bedroom Area	Required Total Bedroom Area	Required Area Met	Total Storage Area	Required Total Storage Area	Required Area Met
48.4 m <sup>2</sup>	45.0 m <sup>2</sup>	Yes	27.0 m <sup>2</sup>	23.0 m <sup>2</sup>	Yes	11.6 m <sup>2</sup>	11.4 m <sup>2</sup>	Yes	3.0 m <sup>2</sup>	3.0 m <sup>2</sup>	Yes

① E-1B-I  
1:100

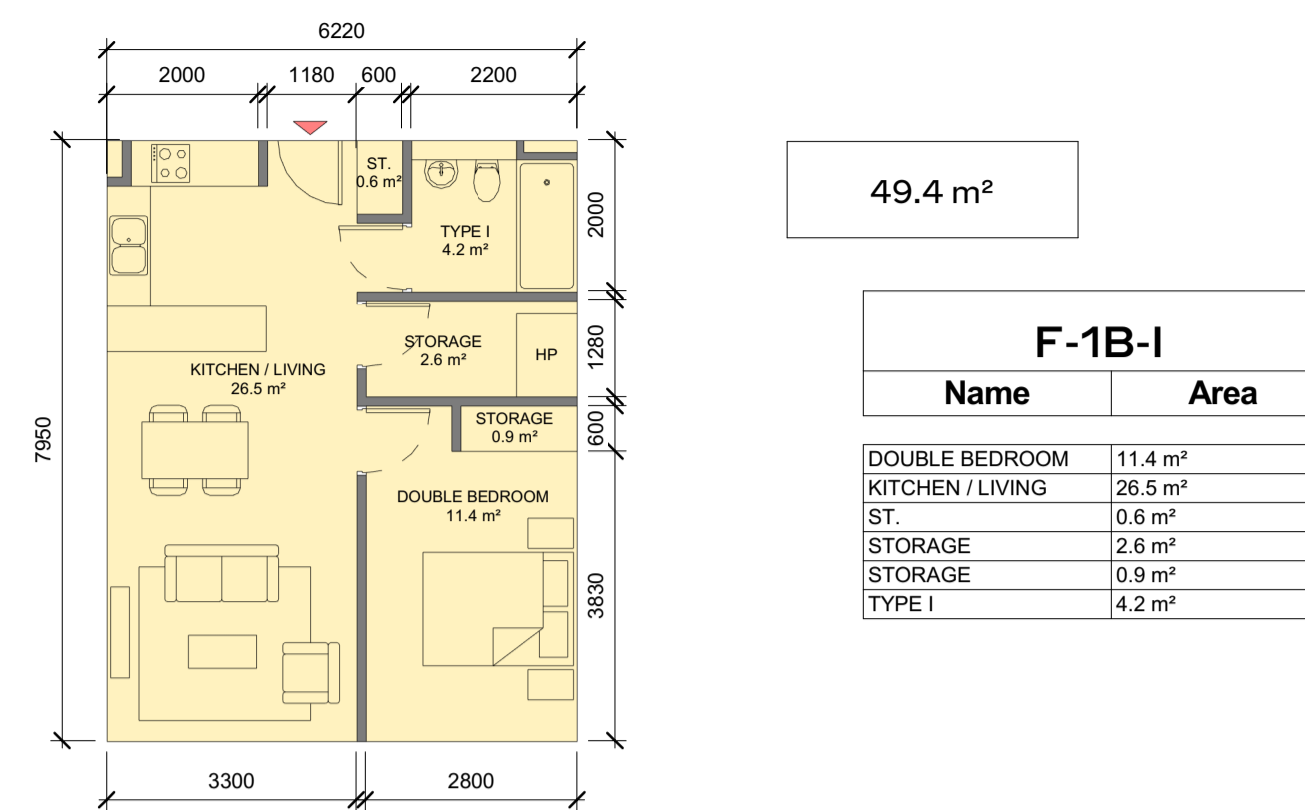

F-1B-I - SPACE REQUIREMENTS											
Apartment Area	Required Apartment Area	Required Area Met	Kitchen - Living Area	Required Kitchen - Living Area	Required Area Met	Total Bedroom Area	Required Total Bedroom Area	Required Area Met	Total Storage Area	Required Total Storage Area	Required Area Met
49.4 m <sup>2</sup>	45.0 m <sup>2</sup>	Yes	26.5 m <sup>2</sup>	23.0 m <sup>2</sup>	Yes	11.4 m <sup>2</sup>	11.4 m <sup>2</sup>	Yes	4.1 m <sup>2</sup>	3.0 m <sup>2</sup>	Yes

② F-1B-I  
1:100

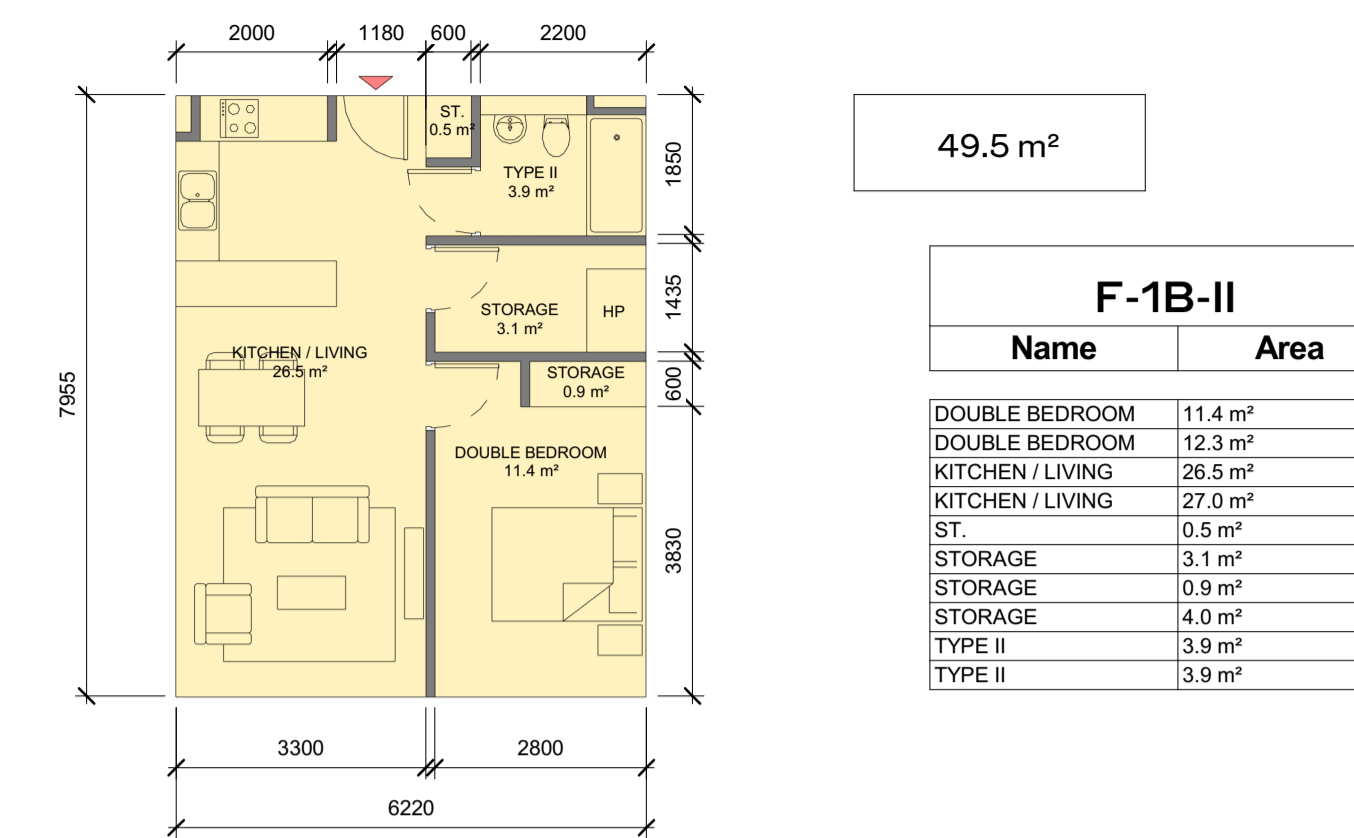

F-1B-II - SPACE REQUIREMENTS											
Apartment Area	Required Apartment Area	Required Area Met	Kitchen - Living Area	Required Kitchen - Living Area	Required Area Met	Total Bedroom Area	Required Total Bedroom Area	Required Area Met	Total Storage Area	Required Total Storage Area	Required Area Met
49.5 m <sup>2</sup>	45.0 m <sup>2</sup>	Yes	26.5 m <sup>2</sup>	23.0 m <sup>2</sup>	Yes	11.4 m <sup>2</sup>	11.4 m <sup>2</sup>	Yes	4.5 m <sup>2</sup>	3.0 m <sup>2</sup>	Yes

③ F-1B-II  
1:100

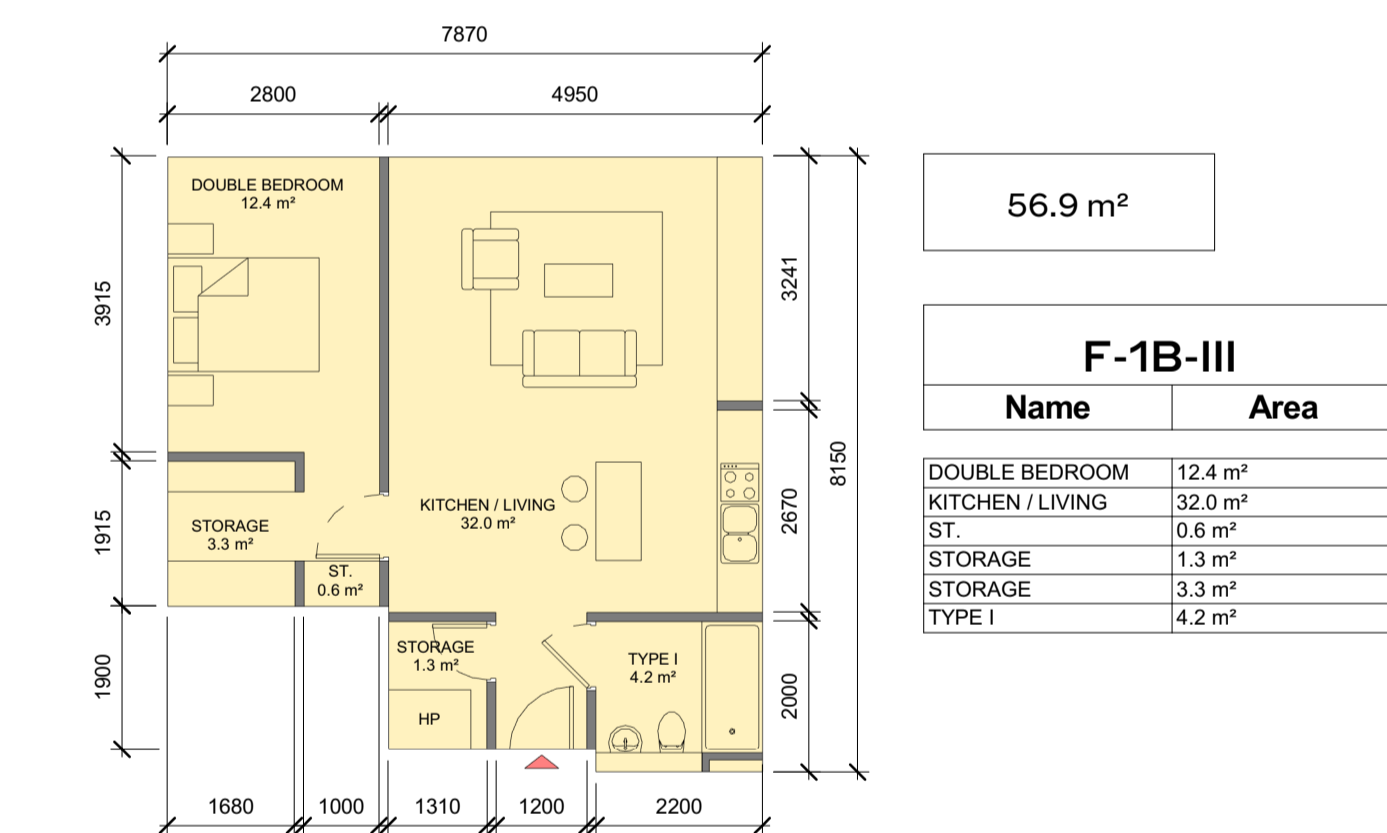

F-1B-III - SPACE REQUIREMENTS											
Apartment Area	Required Apartment Area	Required Area Met	Kitchen - Living Area	Required Kitchen - Living Area	Required Area Met	Total Bedroom Area	Required Total Bedroom Area	Required Area Met	Total Storage Area	Required Total Storage Area	Required Area Met
56.9 m <sup>2</sup>	45.0 m <sup>2</sup>	Yes	32.0 m <sup>2</sup>	23.0 m <sup>2</sup>	Yes	12.4 m <sup>2</sup>	11.4 m <sup>2</sup>	Yes	5.2 m <sup>2</sup>	3.0 m <sup>2</sup>	Yes

④ F-1B-III  
1:100

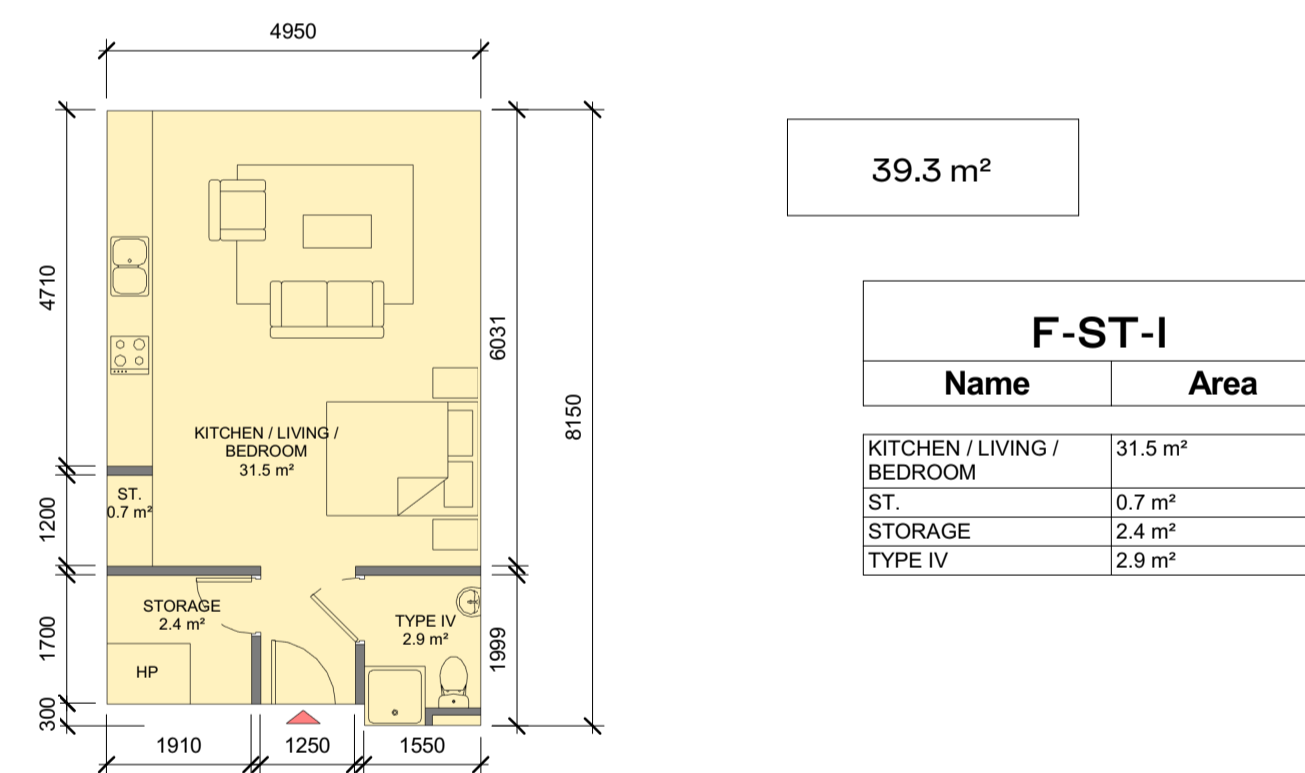

F-ST-I - SPACE REQUIREMENTS											
Apartment Area	Required Apartment Area	Required Area Met	Kitchen - Living Area	Required Kitchen - Living Area	Required Area Met	Total Bedroom Area	Required Total Bedroom Area	Required Area Met	Total Storage Area	Required Total Storage Area	Required Area Met
39.3 m <sup>2</sup>	37.0 m <sup>2</sup>	Yes	31.5 m <sup>2</sup>	30.0 m <sup>2</sup>	Yes	31.5 m <sup>2</sup>	30.0 m <sup>2</sup>	Yes	3.1 m <sup>2</sup>	3.0 m <sup>2</sup>	Yes

⑤ F-ST-I  
1:100

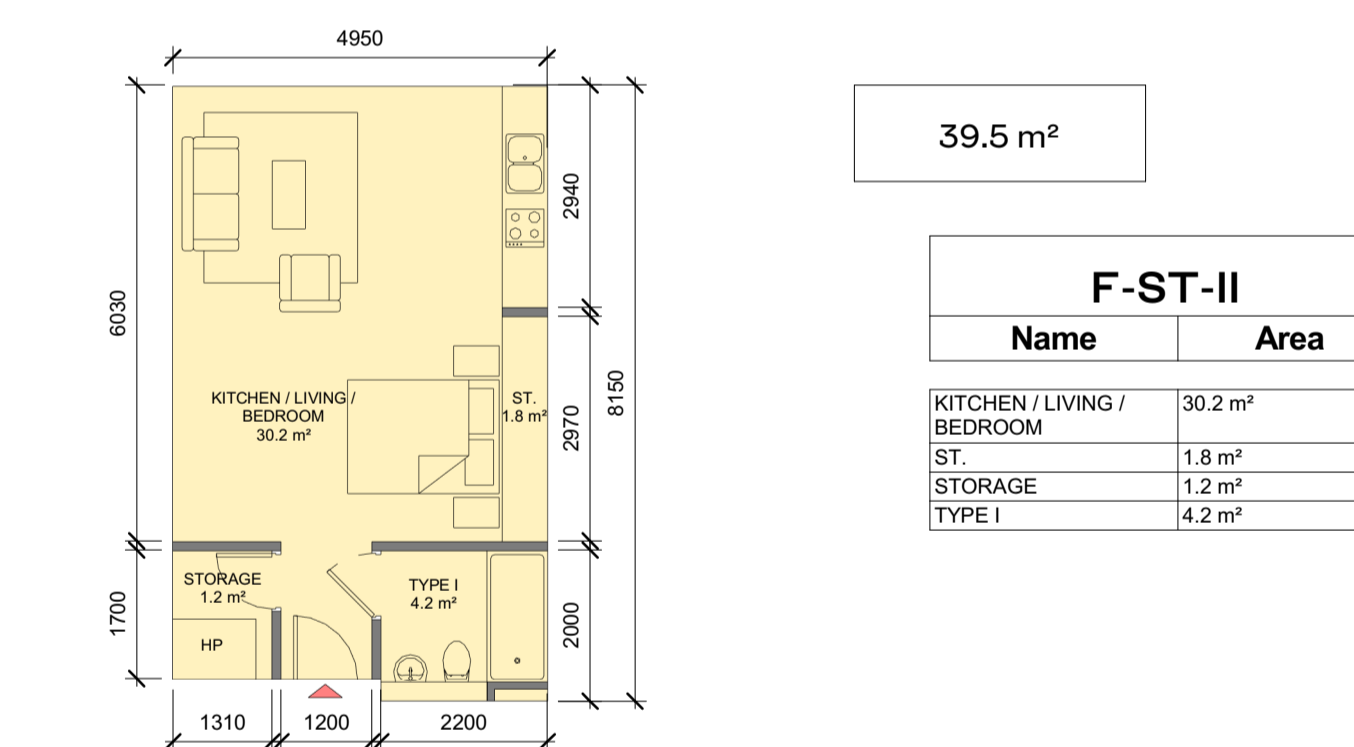

F-ST-II - SPACE REQUIREMENTS											
Apartment Area	Required Apartment Area	Required Area Met	Kitchen - Living Area	Required Kitchen - Living Area	Required Area Met	Total Bedroom Area	Required Total Bedroom Area	Required Area Met	Total Storage Area	Required Total Storage Area	Required Area Met
39.5 m <sup>2</sup>	37.0 m <sup>2</sup>	Yes	30.2 m <sup>2</sup>	30.0 m <sup>2</sup>	Yes	30.2 m <sup>2</sup>	30.0 m <sup>2</sup>	Yes	3.0 m <sup>2</sup>	3.0 m <sup>2</sup>	Yes

⑥ F-ST-II  
1:100

REV	DATE	DESCRIPTION	CHK	DRN
A2	15.11.2019	ISSUED FOR PLANNING APPROVAL	RJ	HJL
A1	18.07.2019	ISSUED FOR ABP PRE-APPLICATION	RJ	BM

ISSUED FOR PLANNING APPROVAL

CLIENT  
SANDYFORD GP Ltd.

PROJECT  
SANDYFORD CENTRAL

DRAWING  
PROPOSED APARTMENTS BLOCK E & F

PROJECT NUMBER  
950572

DATE  
18/07/2019

SCALE@ A1:  
1:100

DRAWN/CHECKED:  
SR/SR

REVISION DRAWING NUMBER STATUS CODE:  
A2 SFC-HJL-XX-ZZ-DR-A-8104 A1

**Henry J Lyons**